













# PEPPERDINE UNIVERSITY



## CAMPUS ACCESSIBILITY MAPS



*Malibu Campus*

- |   |   |
|---|---|
|  ATM               |  Information Directory |
|  Bookstore         |  Main Entrance         |
|  Box Office        |  Restrooms             |
|  Coffee Cart       |  Shuttle Stop          |
|  Convenience Store |  Smoking Area*         |
|  Food Service      |  Tech Central          |

\* Smoking is permitted only at designated locations in plaza areas.



# SEAVER CENTRAL CAMPUS

**ADDITIONAL INFORMATION:**  
 For Emergencies, call Public Safety at (310) 506-4441. Do not dial 911.  
 Malibu Campus Main Telephone Number (310) 506-4000.  
 For Accessibility Routes and Information, call Disability Services at (310) 506-6500.

# PEPPERDINE UNIVERSITY

## Table of Content

Pendleton Learning Center - 1st Floor .....	1
Huntsinger Academic Center, Payson Library - 2nd Floor .....	2
Huntsinger Academic Center, Payson Library - 3rd Floor .....	3
Thornton Administrative Center - 1st Floor .....	4
Thornton Administrative Center - 2nd Floor .....	5
Thornton Administrative Center - 3rd Floor .....	6
Thornton Administrative Center - 4th Floor .....	7
Tyler Campus Center - 1st Floor - Loading Dock .....	8
Tyler Campus Center - 2nd Floor .....	9
Tyler Campus Center - 3rd Floor .....	10
Cultural Arts Center - 1st Floor .....	11
Cultural Arts Center - 2nd Floor .....	12
Cultural Arts Center - 3rd Floor .....	13
Cultural Arts Center - 4th Floor .....	14
Firestone Fieldhouse - 1st Floor .....	15
Elkins/Plaza Classrooms - 1st Floor .....	16
Elkins/Plaza Classrooms - 2nd Floor .....	17
Plaza Classrooms .....	18
Drescher Graduate Campus - Parking .....	19
Drescher Graduate Campus, Executive Center - 1st Floor .....	20
Drescher Graduate Campus, Executive Center - 2nd Floor .....	21
Drescher Graduate Campus, Executive Center - 3rd Floor .....	22
Drescher Graduate Campus Map .....	23

This page intentionally left blank.



# PEPPERDINE UNIVERSITY

Pendleton Learning Center - 1st Floor

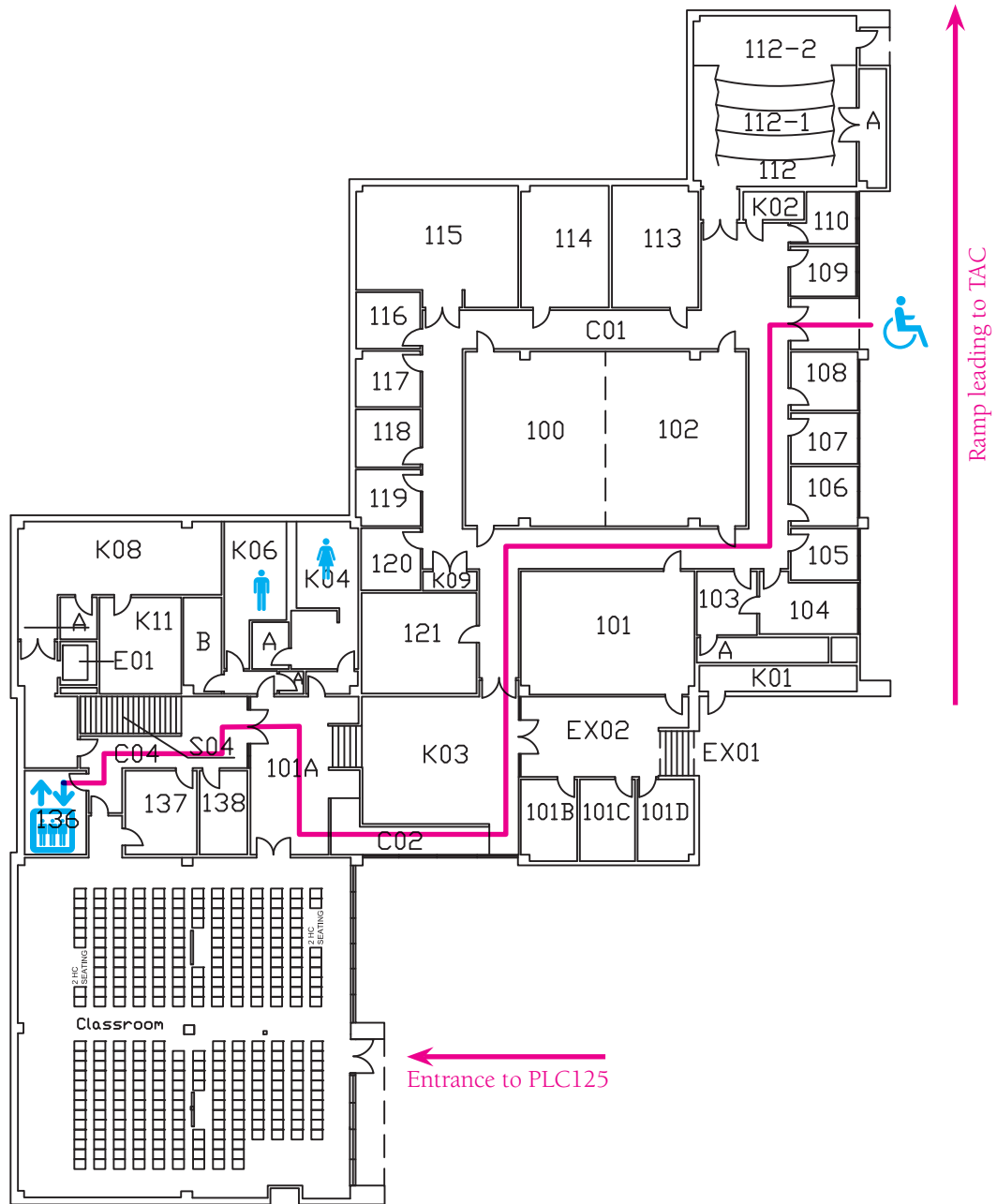

If you have any questions, please contact:  
Disability Services Office (310) 506-6500 (Weekdays: Monday–Friday 8 a.m.–5 p.m.)  
Department of Public Safety (310) 506-4700 (After hours and/or on weekends)

# PEPPERDINE UNIVERSITY

Huntsinger Academic Center, Payson Library - 2nd Floor



Seaver Main Parking Lot

Ramp Down

Entrance

Outside Elevator  
To access upper levels of  
Payson, please see front desk  
receptionist for security key.

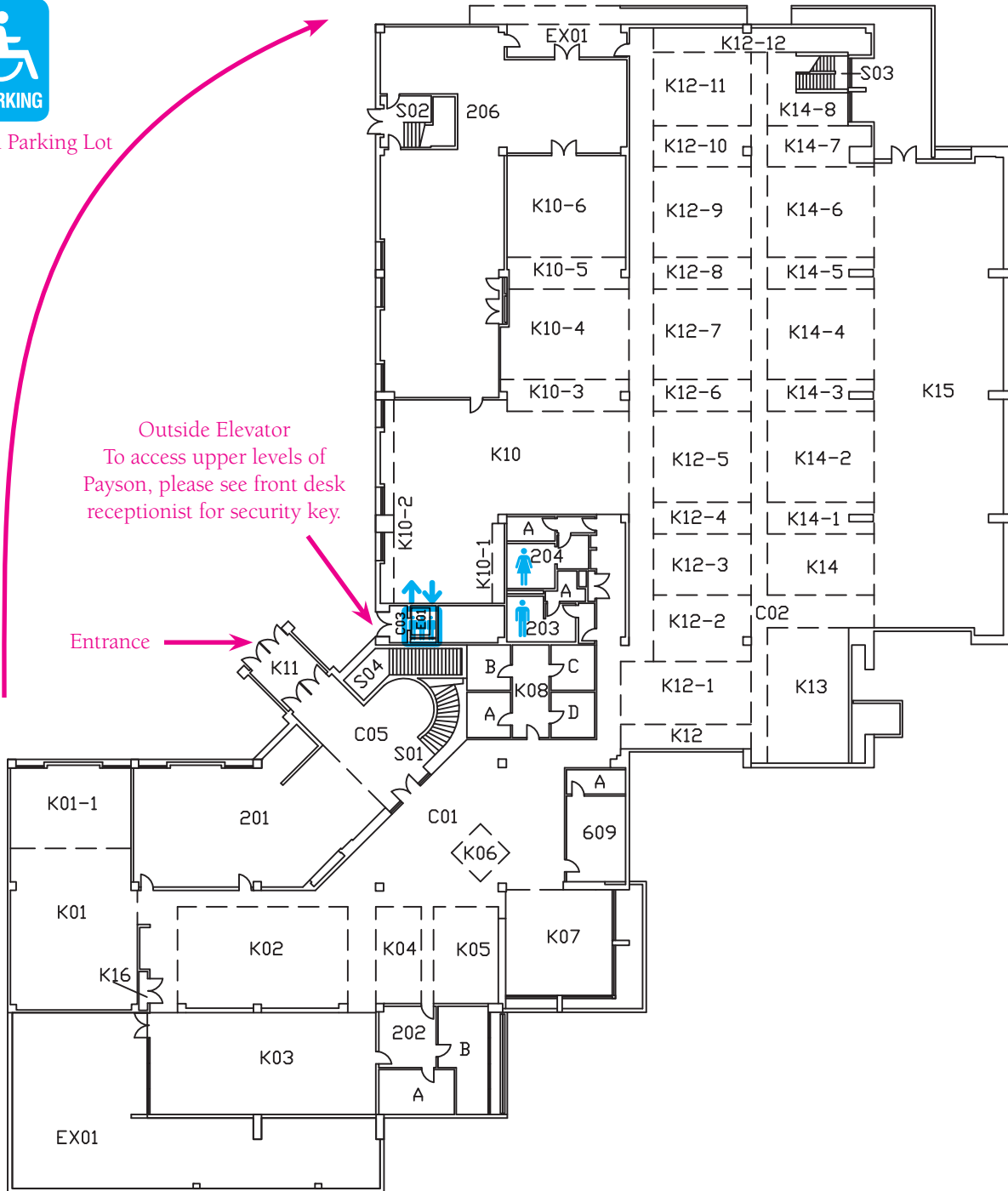

If you have any questions, please contact:

Disability Services Office (310) 506-6500 (Weekdays: Monday–Friday 8 a.m.–5 p.m.)

Department of Public Safety (310) 506-4700 (After hours and/or on weekends)

# PEPPERDINE UNIVERSITY

Huntsinger Academic Center, Payson Library - 3rd Floor

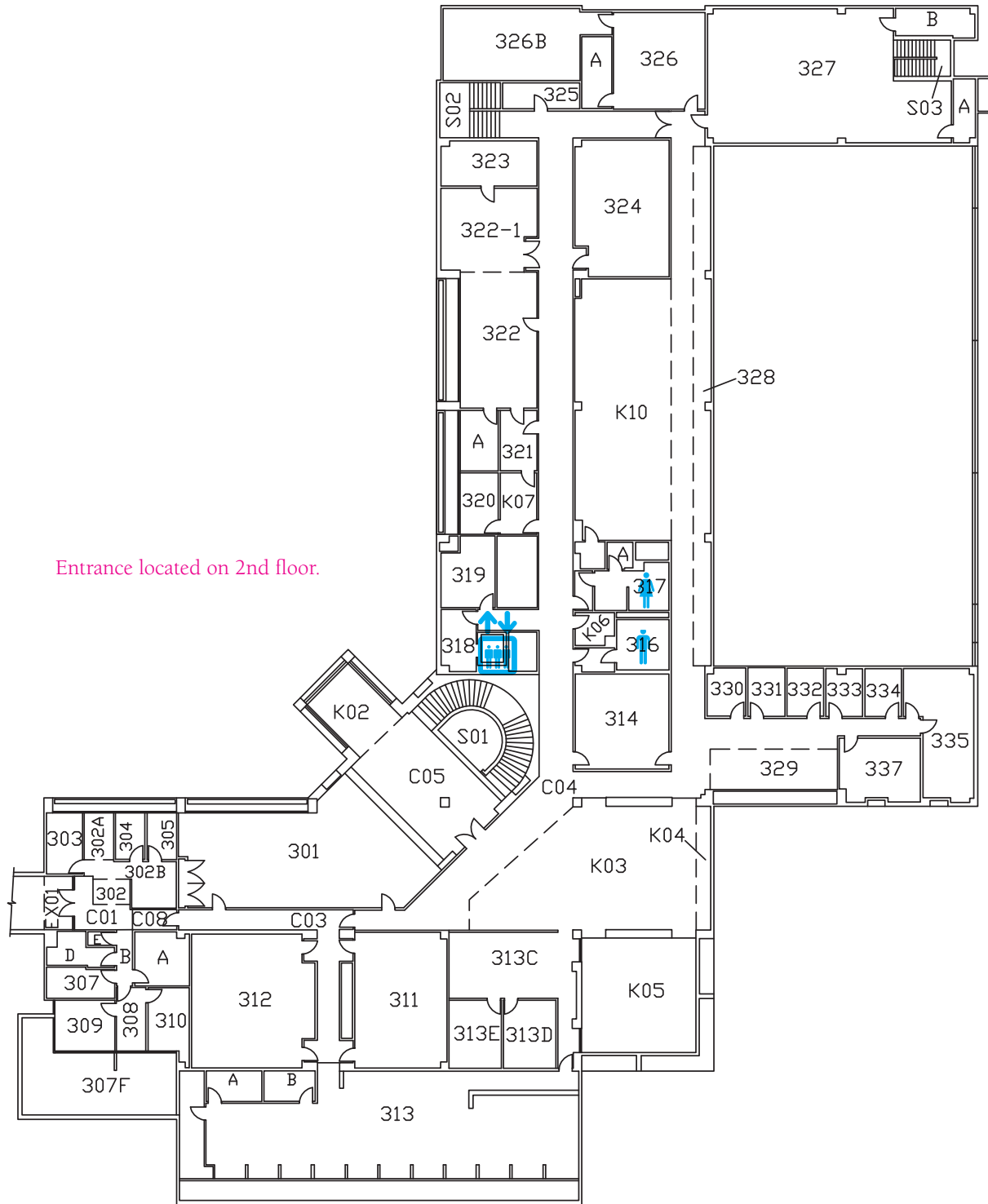

Entrance located on 2nd floor.

If you have any questions, please contact:  
Disability Services Office (310) 506-6500 (Weekdays: Monday–Friday 8 a.m.–5 p.m.)  
Department of Public Safety (310) 506-4700 (After hours and/or on weekends)





# PEPPERDINE UNIVERSITY

Thornton Administrative Center - 2nd Floor

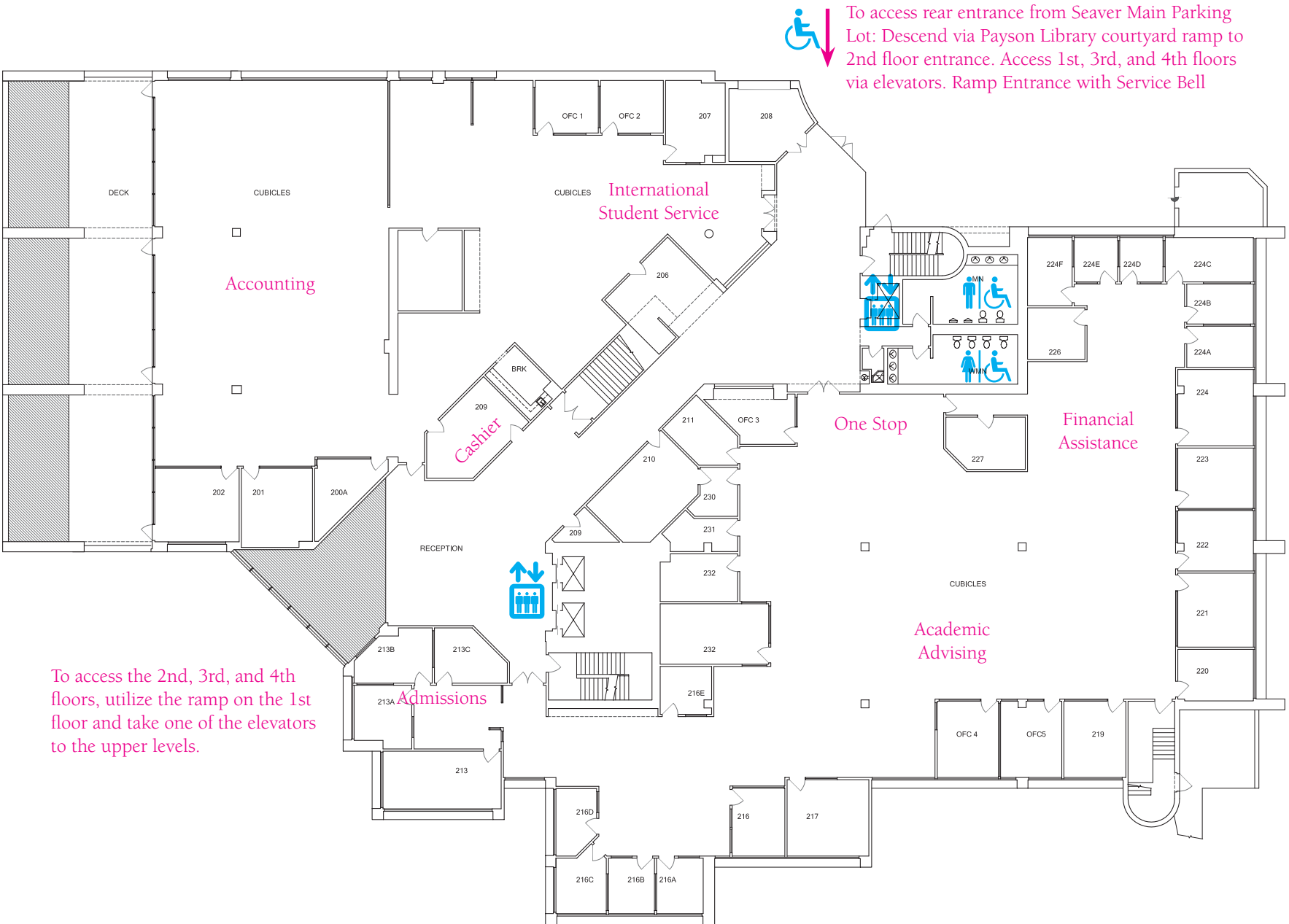

To access rear entrance from Seaver Main Parking Lot: Descend via Payson Library courtyard ramp to 2nd floor entrance. Access 1st, 3rd, and 4th floors via elevators. Ramp Entrance with Service Bell

To access the 2nd, 3rd, and 4th floors, utilize the ramp on the 1st floor and take one of the elevators to the upper levels.

If you have any questions, please contact:

Disability Services Office (310) 506-5500 (Weekdays: Monday–Friday 8 a.m.–5 p.m.)  
Department of Public Safety (310) 506-4700 (After hours and/or on weekends)

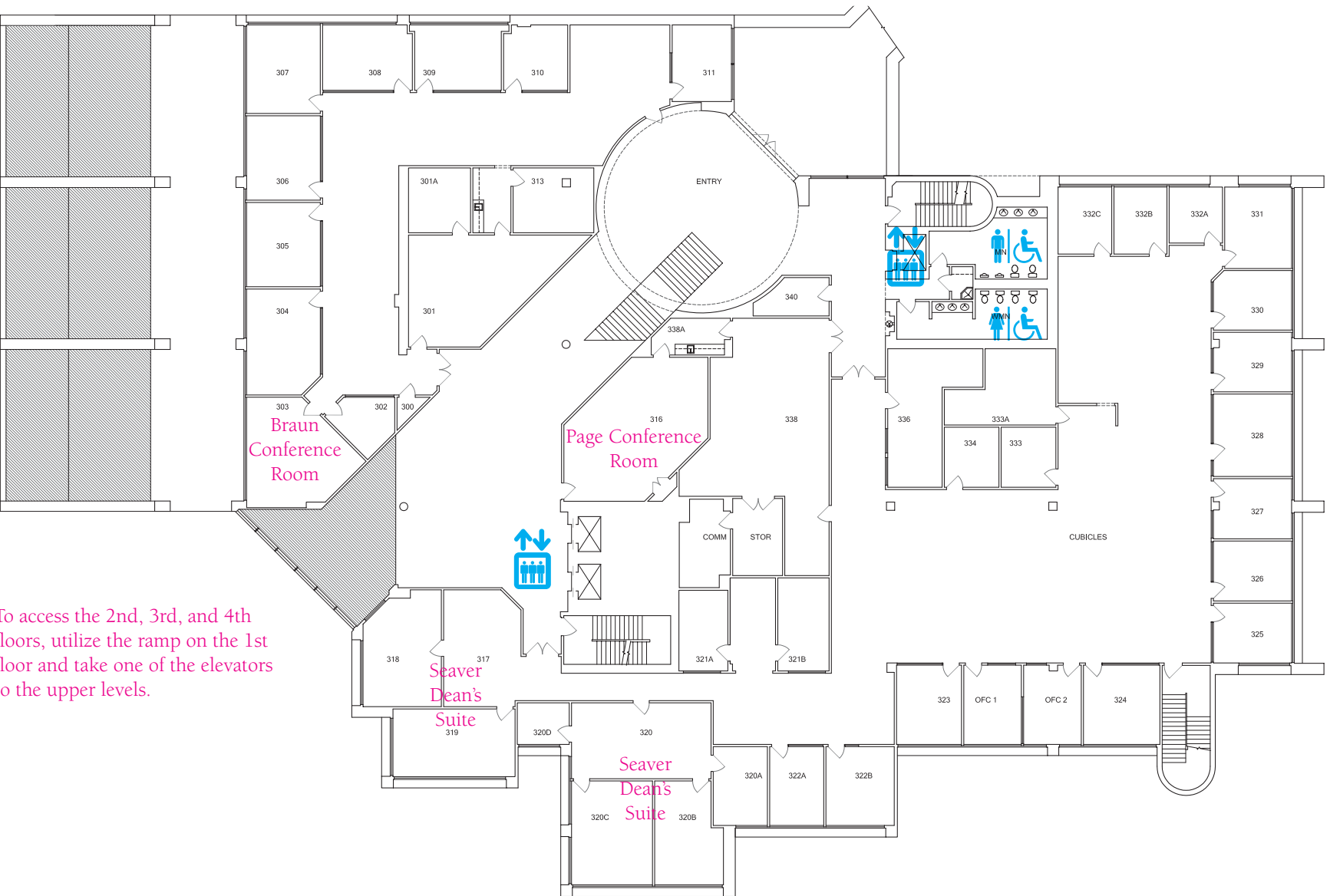

To access the 2nd, 3rd, and 4th floors, utilize the ramp on the 1st floor and take one of the elevators to the upper levels.

If you have any questions, please contact:

Disability Services Office (310) 506-5500 (Weekdays: Monday–Friday 8 a.m.–5 p.m.)

Department of Public Safety (310) 506-4700 (After hours and/or on weekends)

# PEPPERDINE UNIVERSITY

Thornton Administrative Center - 4th Floor

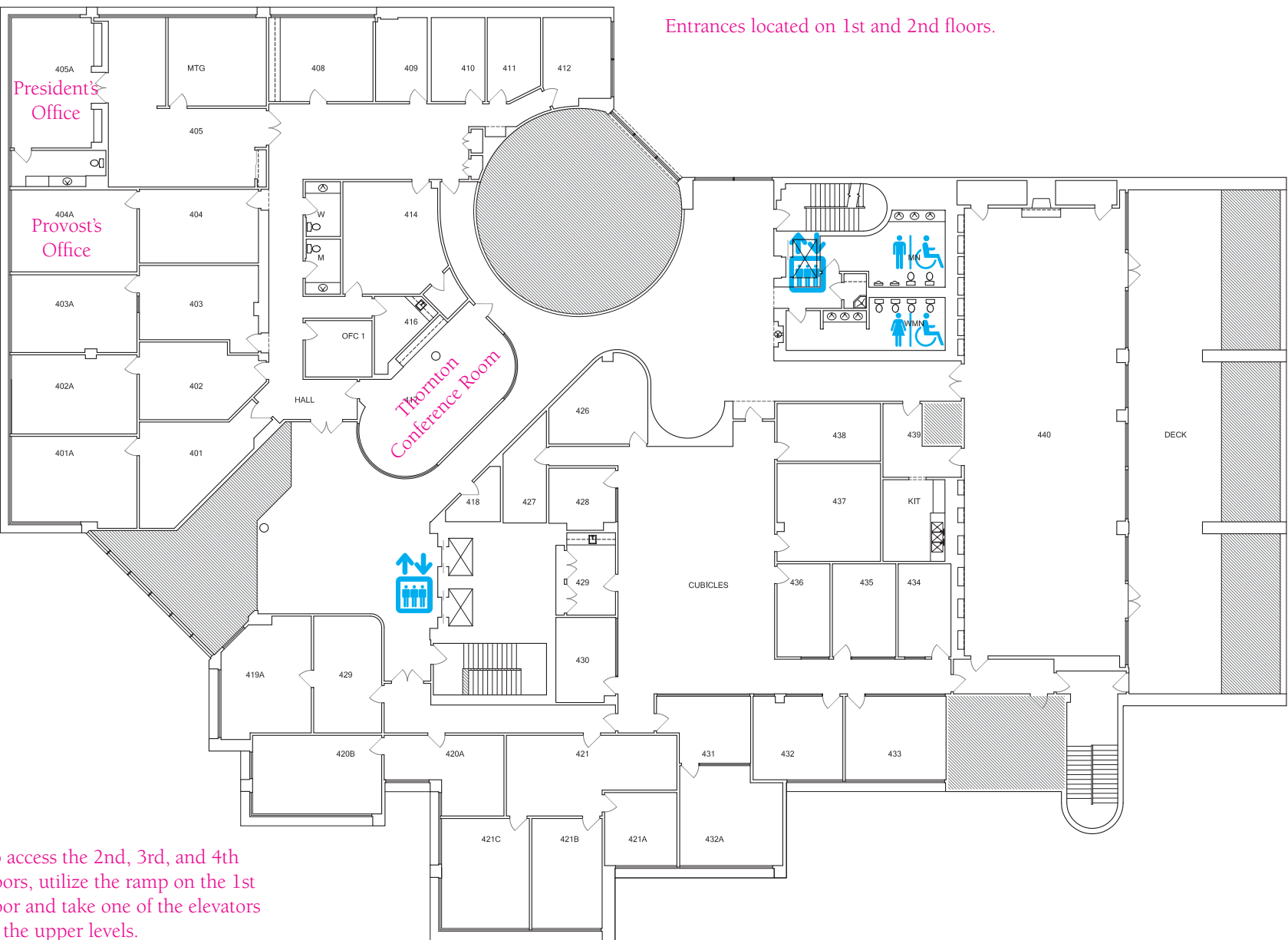

Entrances located on 1st and 2nd floors.

To access the 2nd, 3rd, and 4th floors, utilize the ramp on the 1st floor and take one of the elevators to the upper levels.

If you have any questions, please contact:

Disability Services Office (310) 506-5500 (Weekdays: Monday–Friday 8 a.m.–5 p.m.)

Department of Public Safety (310) 506-4700 (After hours and/or on weekends)

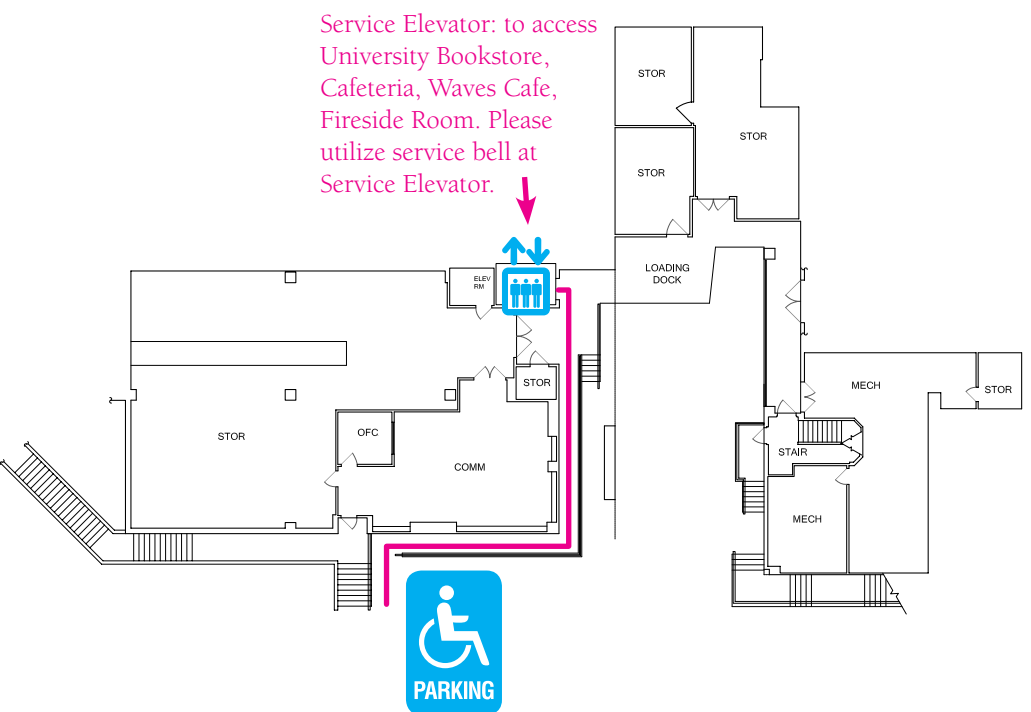

If you have any questions, please contact:

Disability Services Office (310) 506-6500 (Weekdays: Monday–Friday 8 a.m.–5 p.m.)

Department of Public Safety (310) 506-4700 (After hours and/or on weekends)



# PEPPERDINE UNIVERSITY

## Tyler Campus Center - 2nd Floor

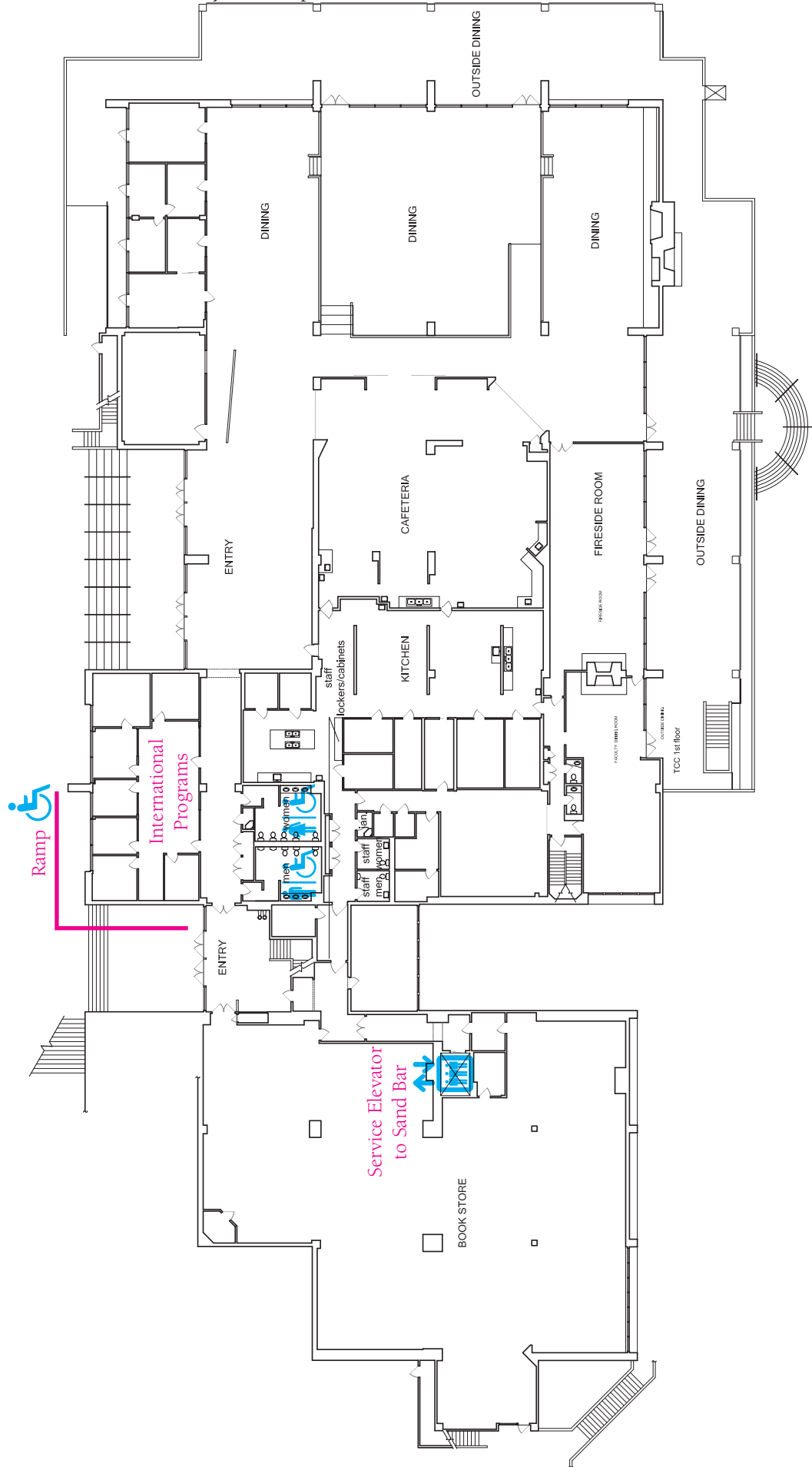

If you have any questions, please contact:  
Disability Services Office (310) 506-6500 (Weekdays: Monday–Friday 8 a.m.–5 p.m.)  
Department of Public Safety (310) 506-4700 (After hours and/or on weekends)

# PEPPERDINE UNIVERSITY

Tyler Campus Center - 3rd Floor

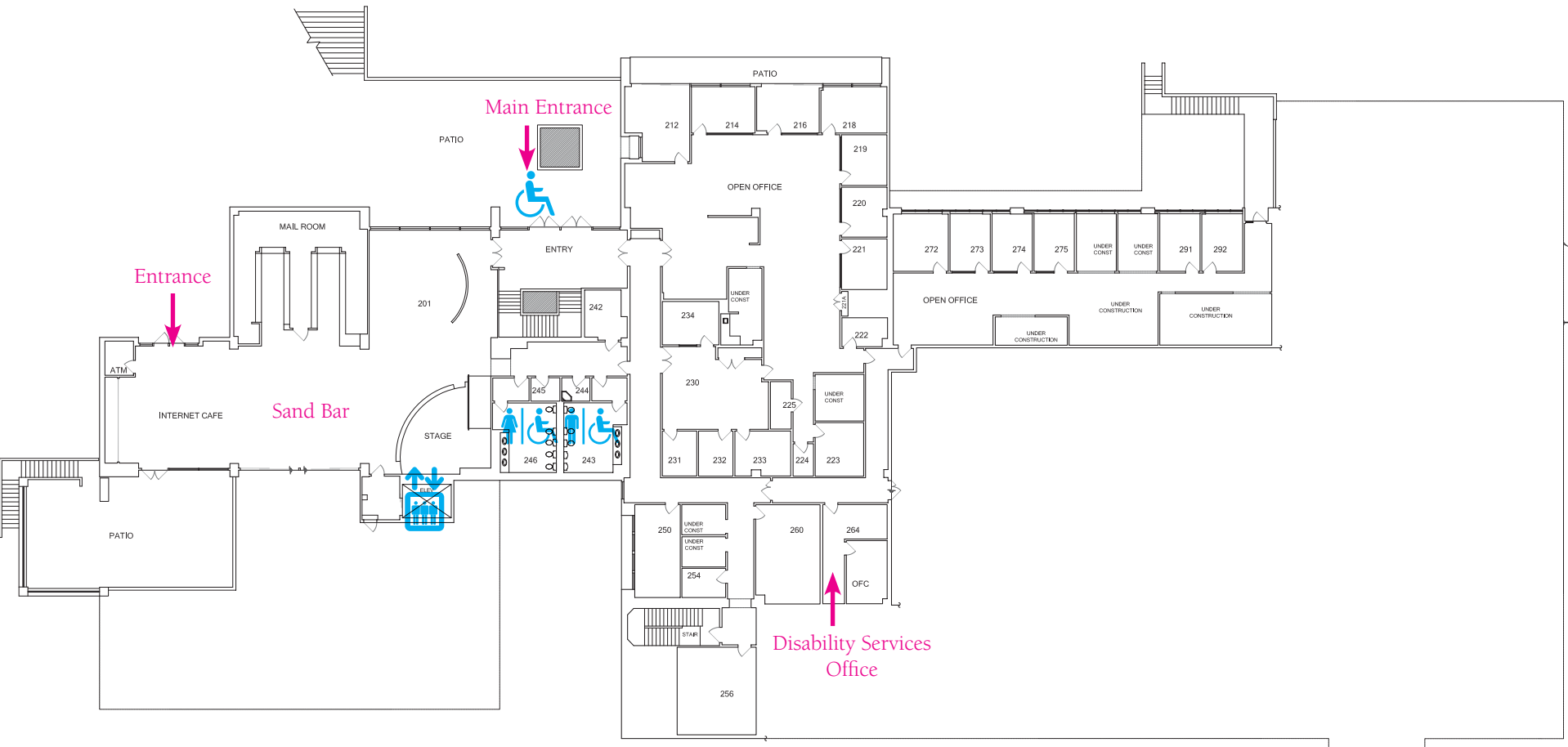

If you have any questions, please contact:

Disability Services Office (310) 506-5500 (Weekdays: Monday–Friday 8 a.m.–5 p.m.)

Department of Public Safety (310) 506-4700 (After hours and/or on weekends)

# PEPPERDINE UNIVERSITY

Cultural Arts Center - 1st Floor

Entrance located on 2nd floor.

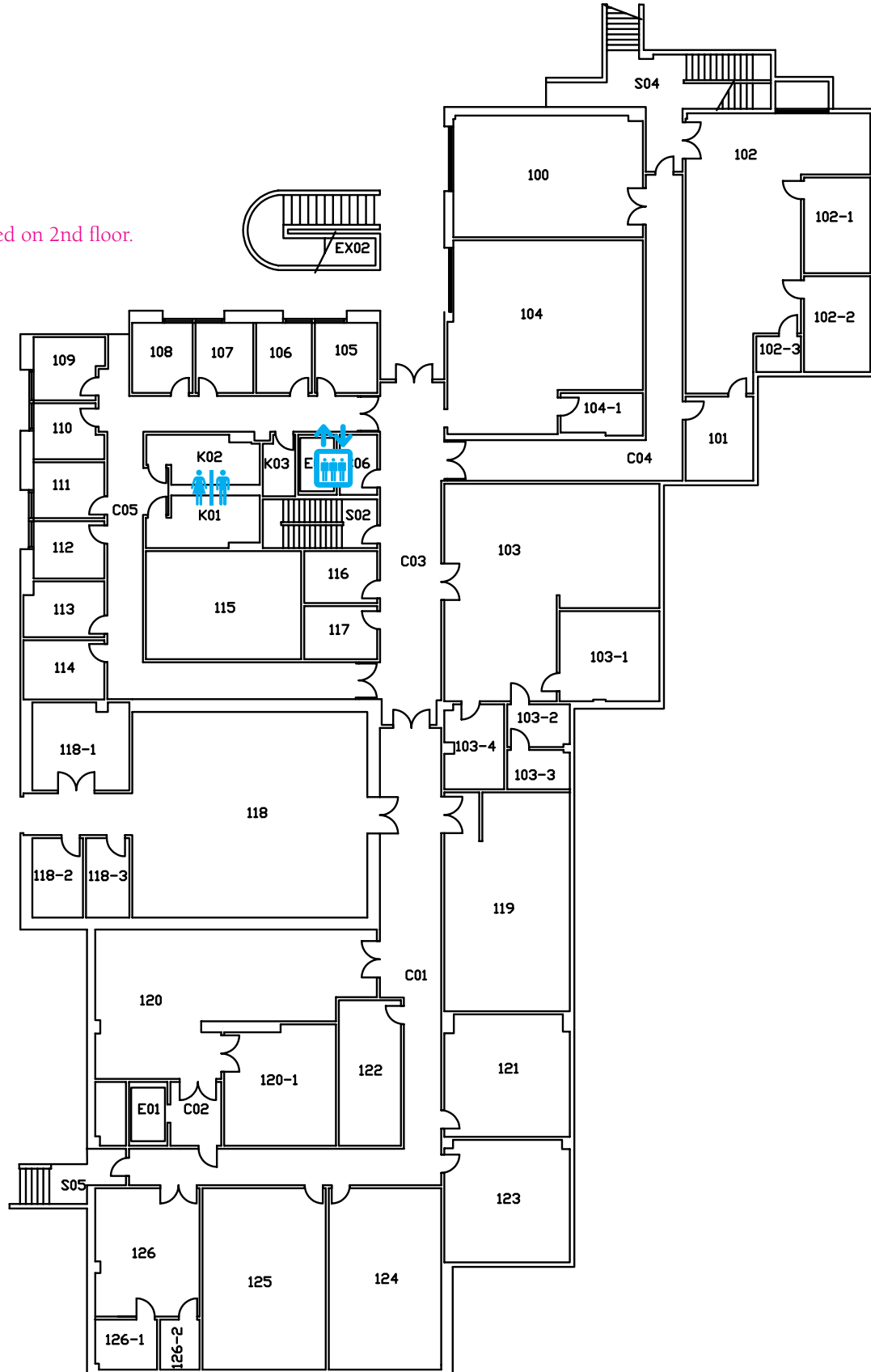

If you have any questions, please contact:  
Disability Services Office (310) 506-6500 (Weekdays: Monday–Friday 8 a.m.–5 p.m.)  
Department of Public Safety (310) 506-4700 (After hours and/or on weekends)

# PEPPERDINE UNIVERSITY

Cultural Arts Center - 2nd Floor

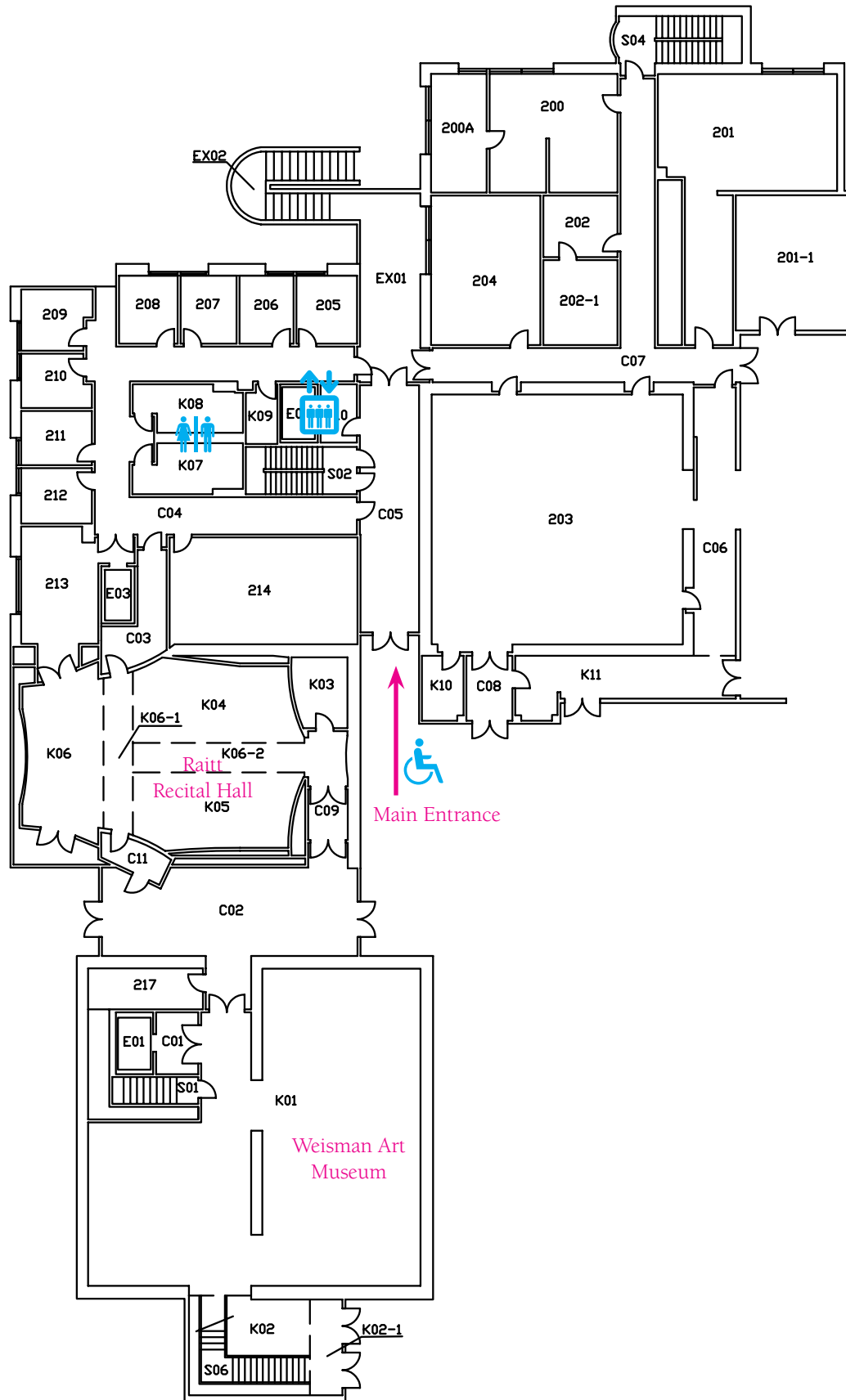

If you have any questions, please contact:

Disability Services Office (310) 506-6500 (Weekdays: Monday–Friday 8 a.m.–5 p.m.)

Department of Public Safety (310) 506-4700 (After hours and/or on weekends)



# PEPPERDINE UNIVERSITY

Cultural Arts Center - 3rd Floor

Entrance located on 2nd floor.

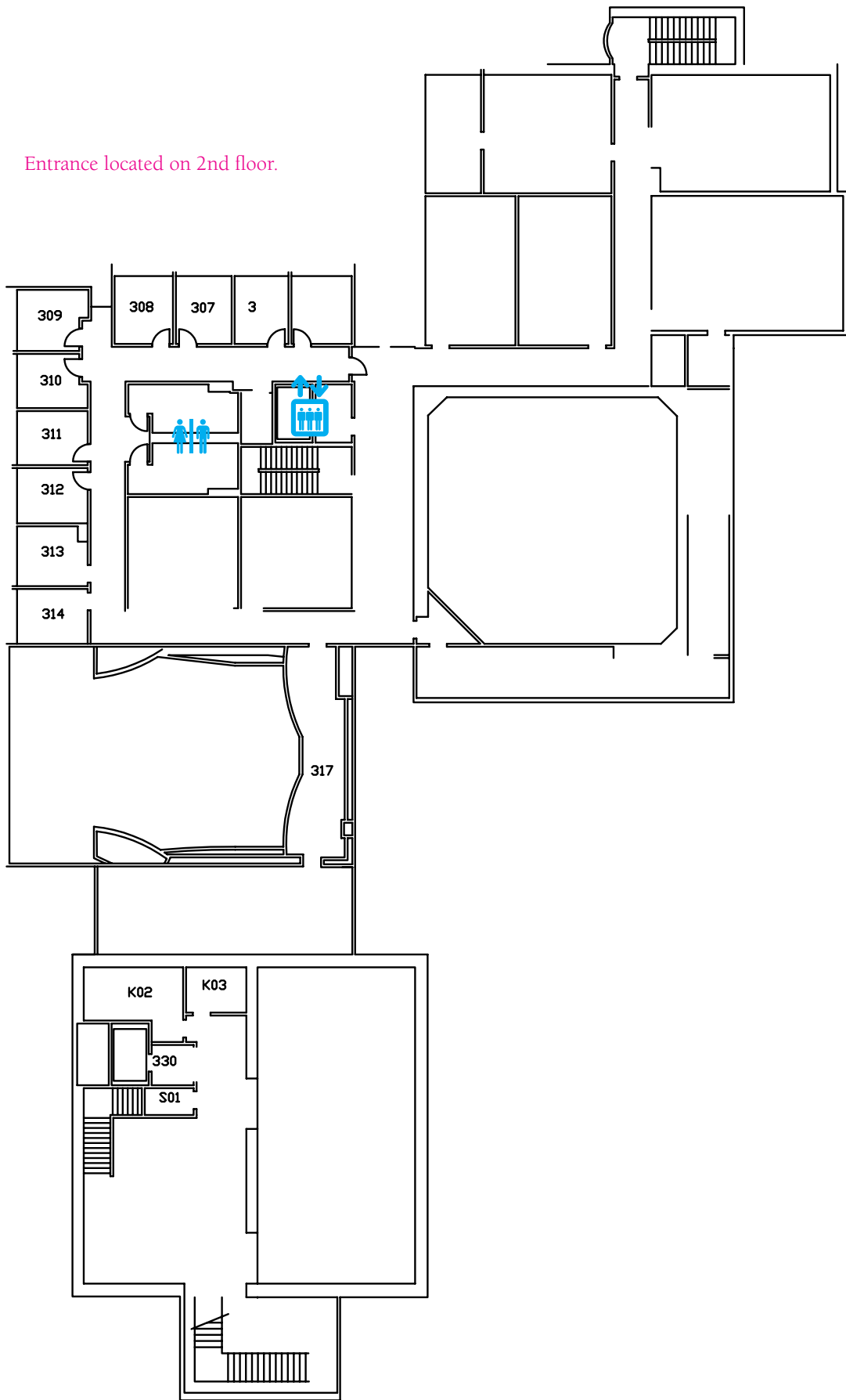

If you have any questions, please contact:  
Disability Services Office (310) 506-6500 (Weekdays: Monday–Friday 8 a.m.–5 p.m.)  
Department of Public Safety (310) 506-4700 (After hours and/or on weekends)

# PEPPERDINE UNIVERSITY

Cultural Arts Center - 4th Floor

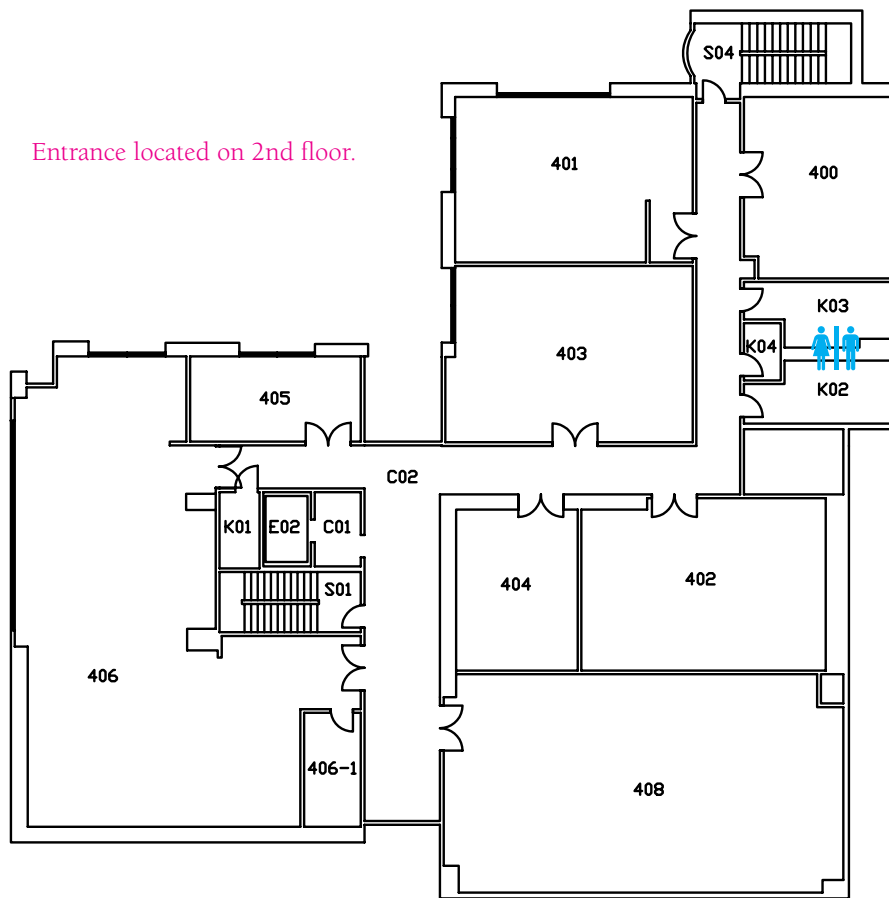

If you have any questions, please contact:

Disability Services Office (310) 506-6500 (Weekdays: Monday–Friday 8 a.m.–5 p.m.)

Department of Public Safety (310) 506-4700 (After hours and/or on weekends)

# PEPPERDINE UNIVERSITY

## Firestone Fieldhouse - 1st Floor

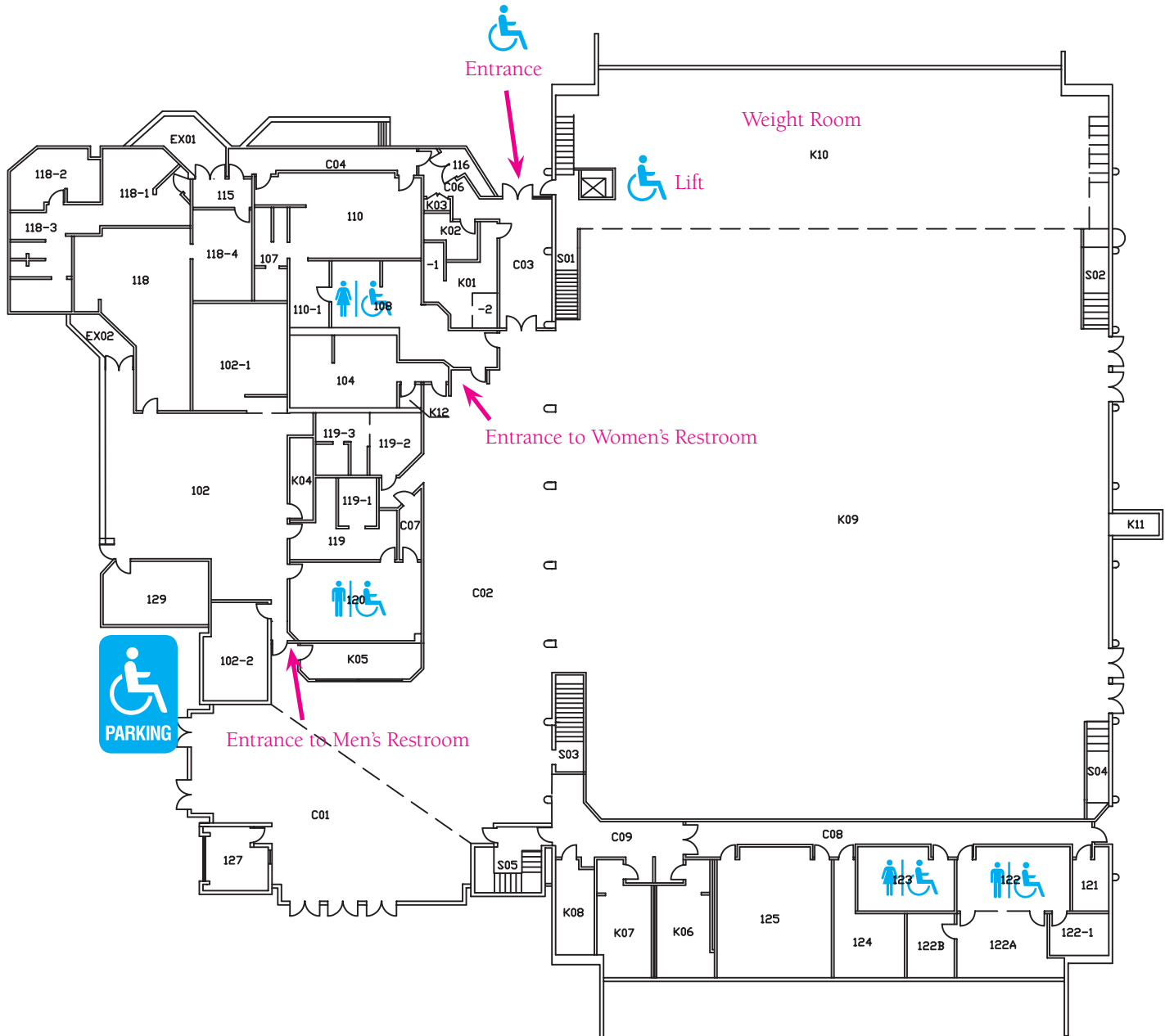

If you have any questions, please contact:  
Disability Services Office (310) 506-6500 (Weekdays: Monday–Friday 8 a.m.–5 p.m.)  
Department of Public Safety (310) 506-4700 (After hours and/or on weekends)

# PEPPERDINE UNIVERSITY

Elkins/Plaza Classrooms - 1st Floor  
Appleby Center & Rockwell Academic Center - 1st Floor

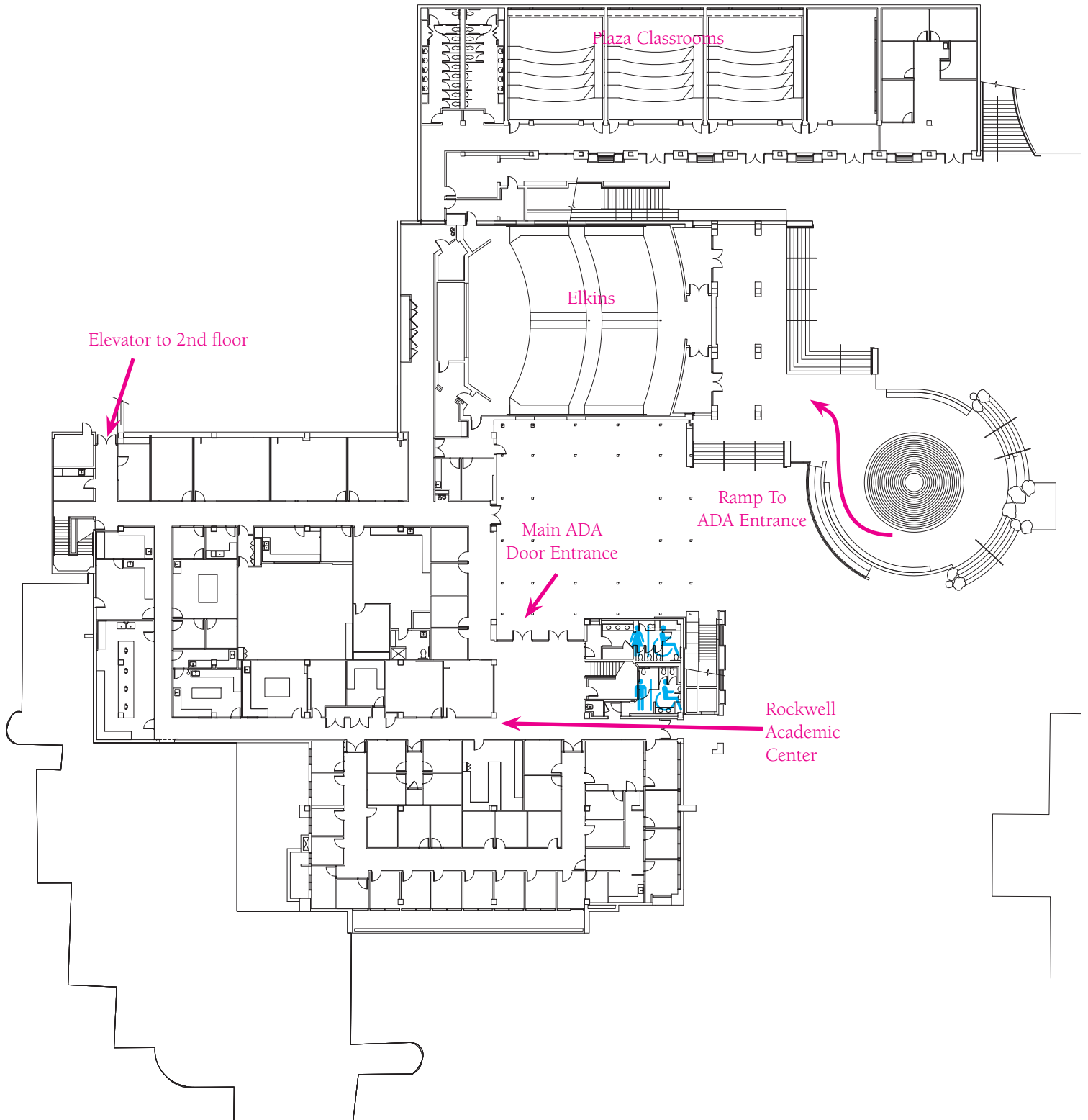

If you have any questions, please contact:  
Disability Services Office (310) 506-6500 (Weekdays: Monday–Friday 8 a.m.–5 p.m.)  
Department of Public Safety (310) 506-4700 (After hours and/or on weekends)



# PEPPERDINE UNIVERSITY

Elkins/Plaza Classrooms - 2nd Floor  
Appleby Center & Rockwell Academic Center - 2nd Floor

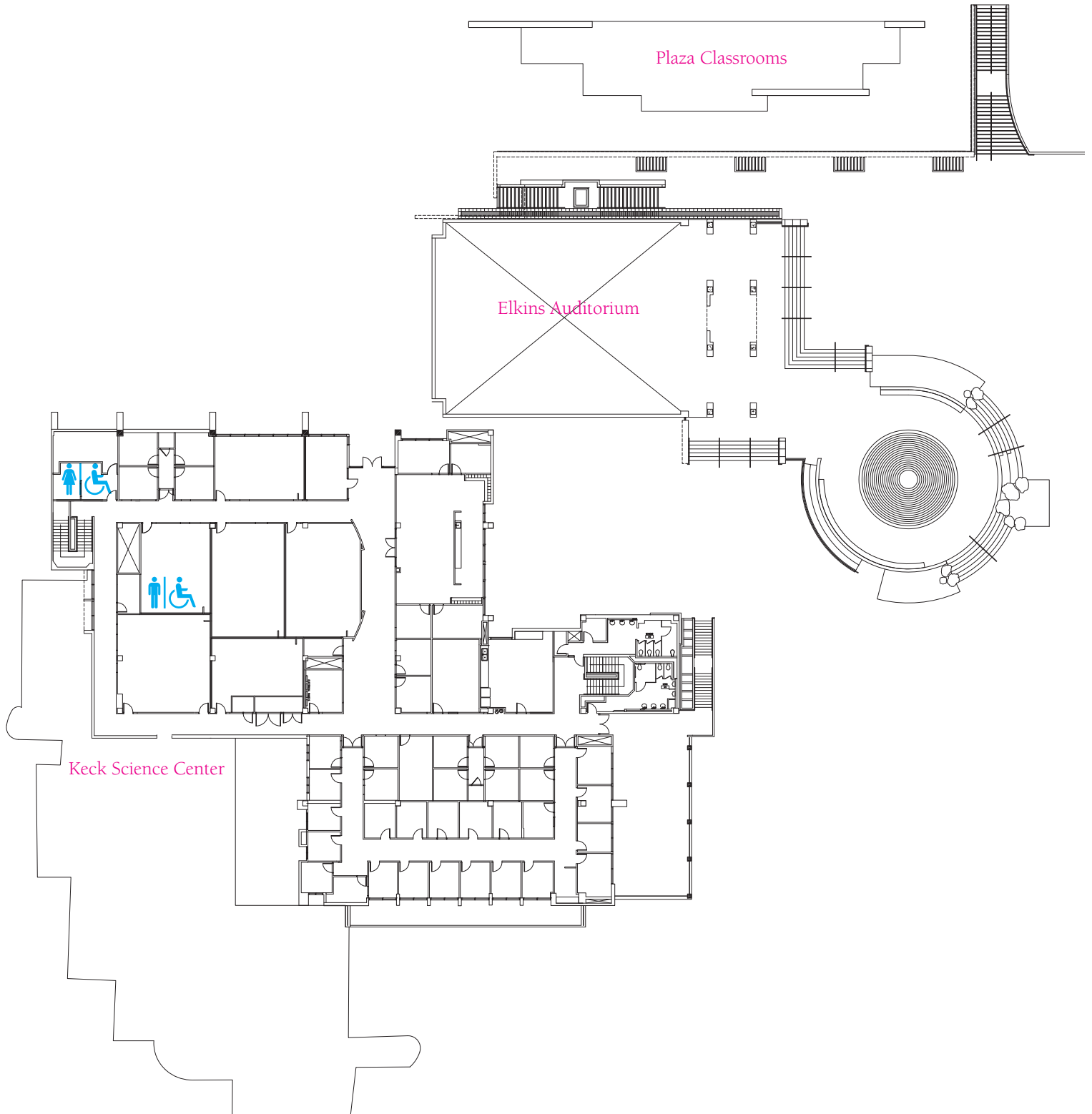

If you have any questions, please contact:  
Disability Services Office (310) 506-6500 (Weekdays: Monday–Friday 8 a.m.–5 p.m.)  
Department of Public Safety (310) 506-4700 (After hours and/or on weekends)

# PEPPERDINE UNIVERSITY

## Plaza Classrooms

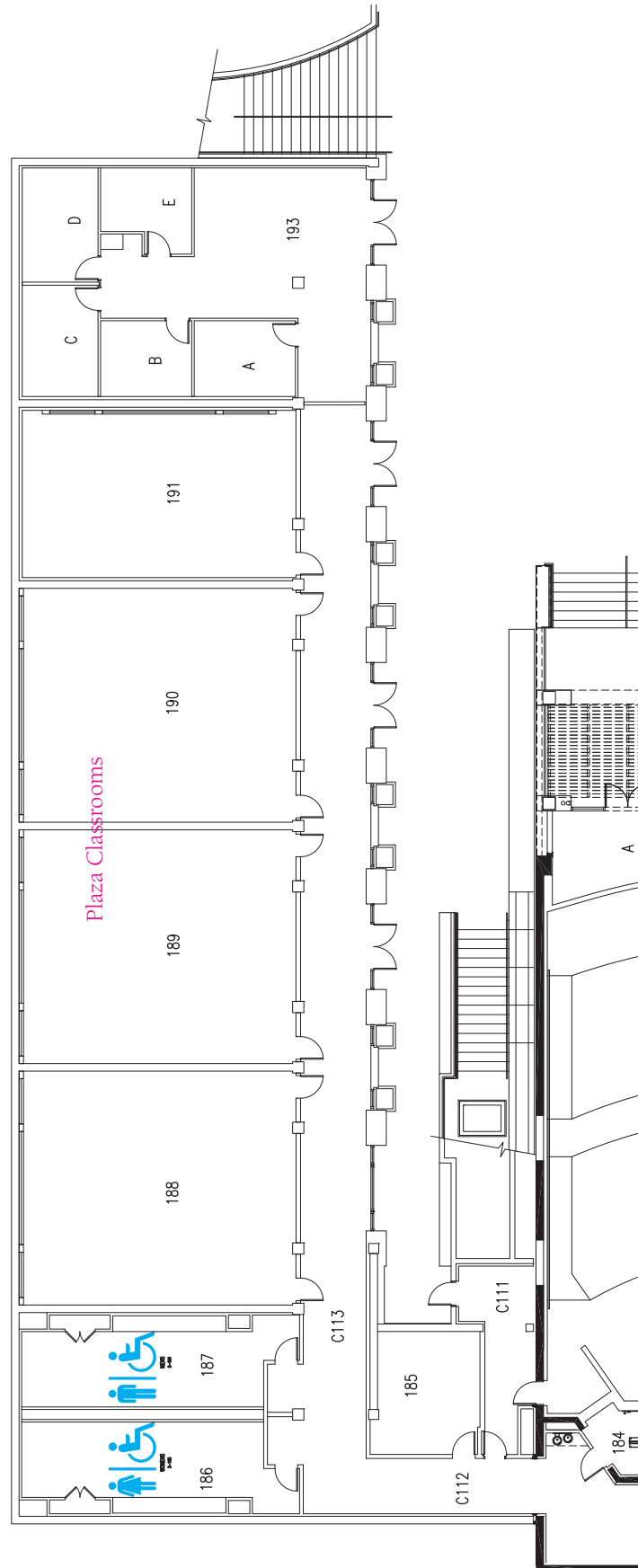

If you have any questions, please contact:

Disability Services Office (310) 506-6500 (Weekdays: Monday–Friday 8 a.m.–5 p.m.)

Department of Public Safety (310) 506-4700 (After hours and/or on weekends)

# PEPPERDINE UNIVERSITY

Drescher Graduate Campus - Parking

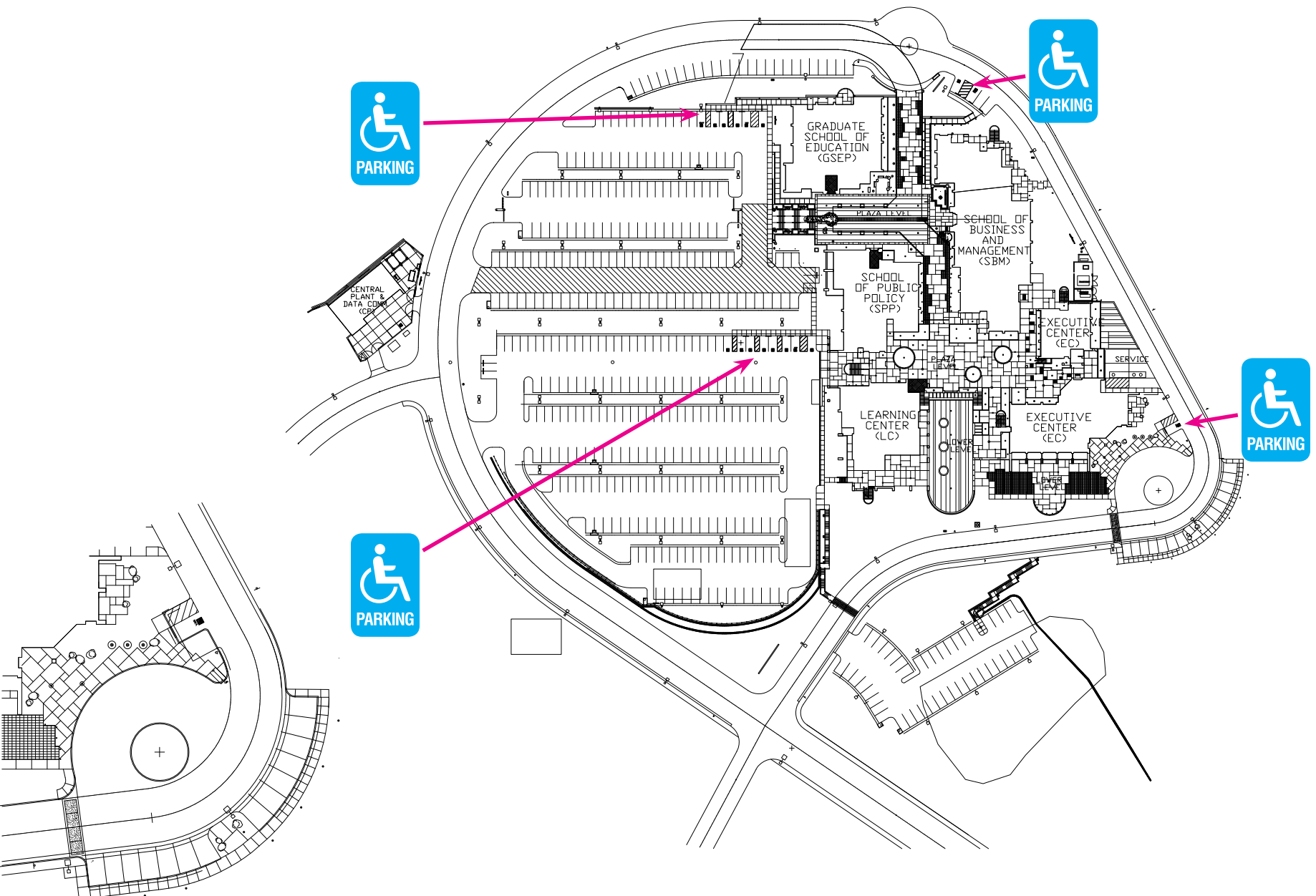

If you have any questions, please contact:

Disability Services Office (310) 506-5500 (Weekdays: Monday–Friday 8 a.m.–5 p.m.)

Department of Public Safety (310) 506-4700 (After hours and/or on weekends)

# PEPPERDINE UNIVERSITY

Drescher Graduate Campus, Executive Center - 1st Floor

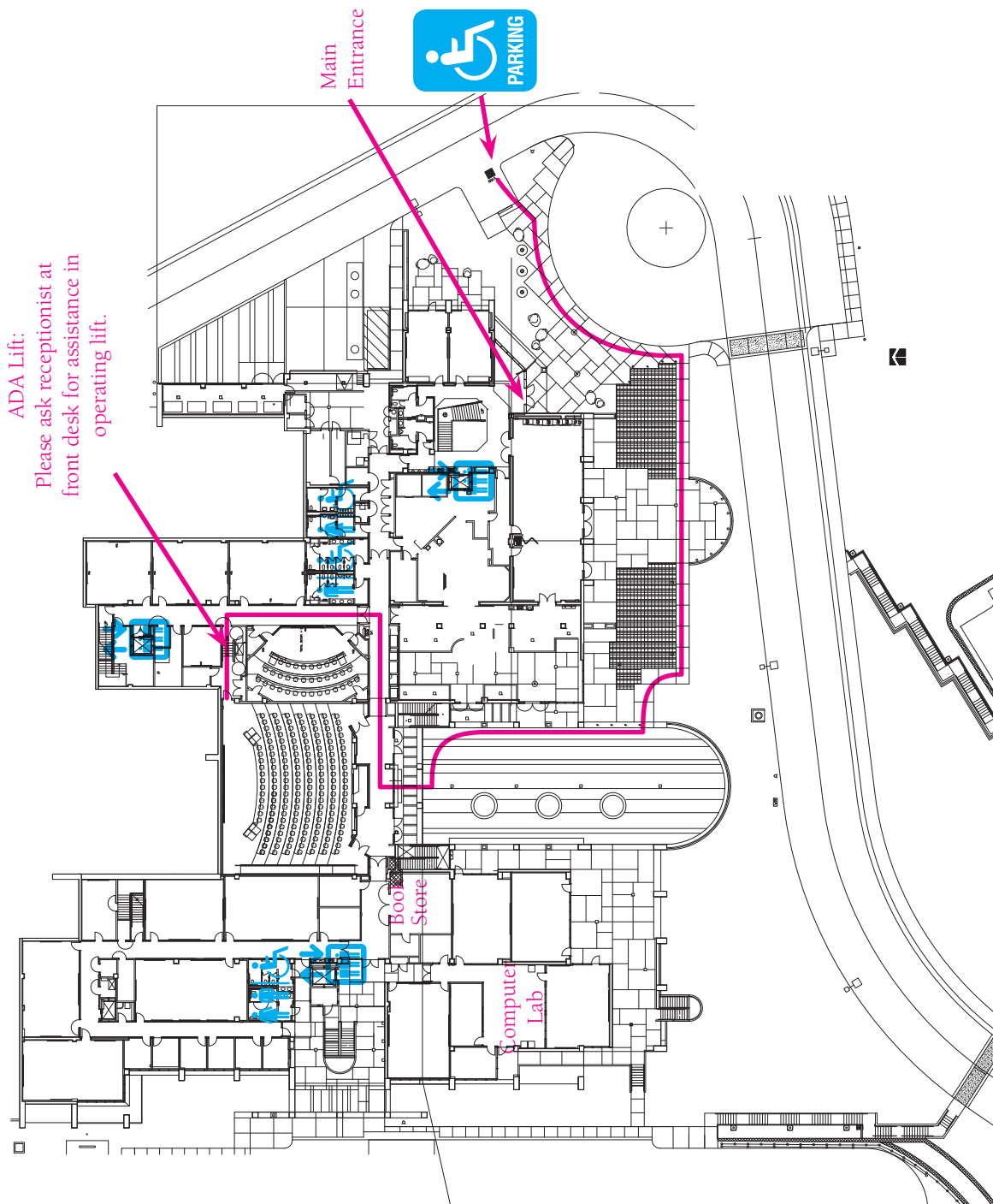

If you have any questions, please contact:  
Disability Services Office (310) 506-6500 (Weekdays: Monday–Friday 8 a.m.–5 p.m.)  
Department of Public Safety (310) 506-4700 (After hours and/or on weekends)

# PEPPERDINE UNIVERSITY

Drescher Graduate Campus, Executive Center - 2nd Floor

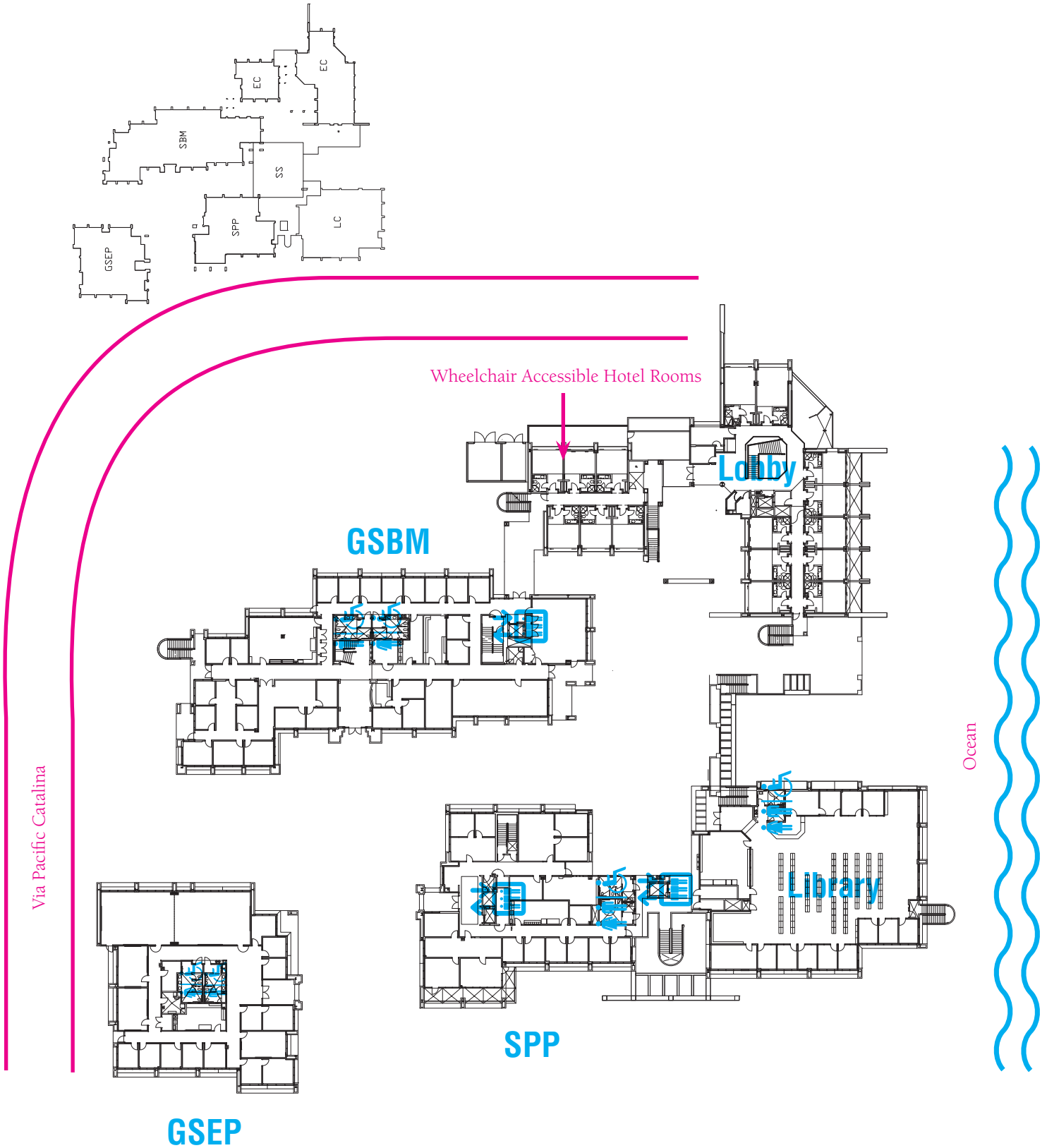

If you have any questions, please contact:  
Disability Services Office (310) 506-6500 (Weekdays: Monday–Friday 8 a.m.–5 p.m.)  
Department of Public Safety (310) 506-4700 (After hours and/or on weekends)

# PEPPERDINE UNIVERSITY

Drescher Graduate Campus, Executive Center - 3rd Floor

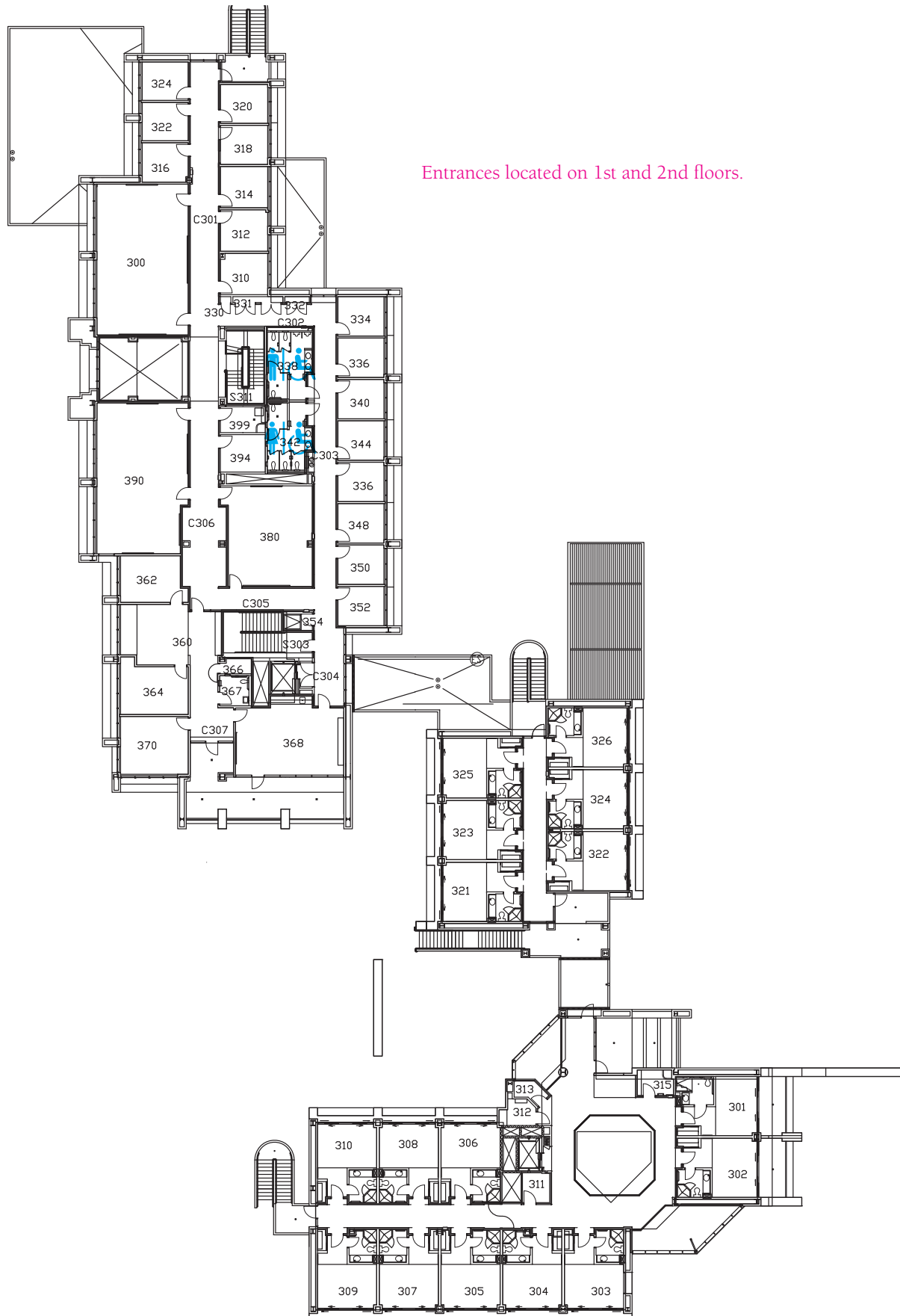

If you have any questions, please contact:  
Disability Services Office (310) 506-6500 (Weekdays: Monday–Friday 8 a.m.–5 p.m.)  
Department of Public Safety (310) 506-4700 (After hours and/or on weekends)



DRESCHER GRADUATE  
CAMPUS MAP

PEPPERDINE UNIVERSITY

Department of Public Safety  
Pepperdine University  
24255 Pacific Coast Highway  
Malibu, California 90263  
(310) 506-4700